

# GOLF COLLECTION



# GOLF COLLECTION

This collection features a custom medium Anigre Cherry finish with simple classic styling with a plinth base. Golf is crafted with hand-selected hardwood solids and veneers and comes with a 5-year contract warranty. Other standard finishes include: Maple, Wild Cherry, Dark Cherry, Medium Oak, Walnut and Mahogany. Granite tops and custom finishes are also available.



Credenza - 4 Drawer  
72" x 24" x 24"H  
(2 drawer also available)



Nightstand  
22" x 20" x 24"H

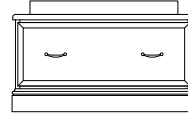

Luggage Bench  
36" x 22" x 18"H  
(false drawer)



Dresser - 6 Drawer  
60" x 24" x 30"H

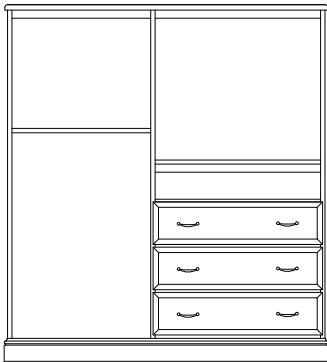

Hospitality Unit  
60" x 24" x 66" H  
(doors optional)

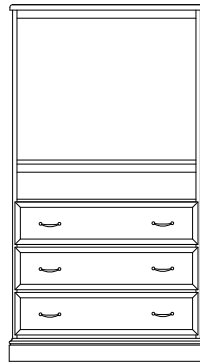

Armoire - 3 Drawer w/ Shelf  
36" x 24" x 66"H  
(doors optional)

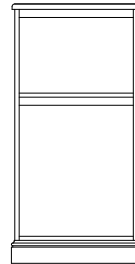

Micro/Fridge Unit  
24" x 22" x 48"H  
(doors optional)



Bachelor Chest - 3 Drawer  
36" x 24" x 30"H



Bachelor Chest w/ Shelf  
36" x 24" x 36"H

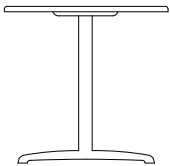

Pedestal Table  
30" Dia. x 30"H

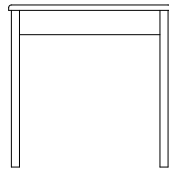

Activity Table  
30" x 30" x 30"H

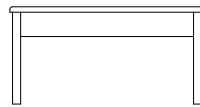

Cocktail Table  
36" x 20" x 18"H

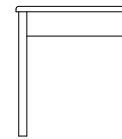

End Table  
22" x 24" x 24"H

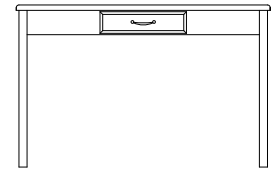

Desk  
46" x 24" x 30"H



Headboard  
Double 54" x 32" H  
Queen 60" x 32" H  
King 78" x 32" H

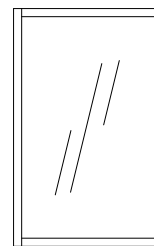

Standard Mirror  
28" x 44"H

**DIRECTLINE HOSPITALITY**  
CONTRACT MANUFACTURING

637 South 48th Street, Suite 201 ▪ Tempe, Arizona 85281  
Phone: 480.776.5850 ▪ Fax: 480.776.5851 ▪ email: sales@dlhospitality.com  
www.dlhospitality.com